



These instructions are to be used with the following Zodiac spare parts kit:

R0682000

MX8™ Factory Tune Up Kit
(for MX8 Gen 2)

Tune Up Kit

Installation Instructions

WARNING

WARNING - This product must be serviced by a qualified professional with sufficient experience in pool equipment installation and maintenance so that all of the instructions in the product's complete installation and operations manual can be followed exactly. All safety instructions in the complete manual must be followed explicitly in order to prevent injury hazards. Improper installation and/or operation will void the warranty.

Check the Box

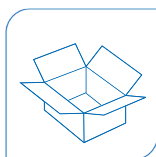

Before starting the procedure, check the box to ensure all the parts listed below are in your kit. If any parts are missing from the kit, please call your local distributor for assistance.

- MX8™ Engine
- MX8™ Drive Shaft (2)
- Bearings (2)
- MX8™ Reversing Assembly - Side A (1), Side B (1)
- MX8™ Tracks (2)

Tools You Will Need



You will need the following tools to do the Tune Up:

- Philips #2 Screwdriver
- Short-handled Philips Screwdriver
- Small Flathead Screwdriver

1 Remove Tracks



- Remove each of the worn tracks and discard.
- Push the yellow latch release button to open the top of the cleaner.

2 Remove 8 Screws and Engine Housing

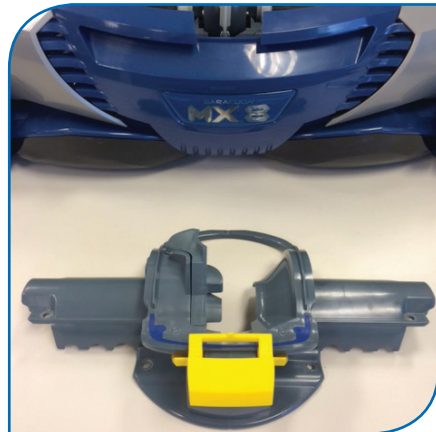

- Using a Philips screwdriver, remove eight (8) screws.
- Remove engine housing. Slowly push engine paddles forward or backward so they are clear of the housing. Make sure the cleaner wheels can move freely as they will turn as the paddles rotate.

3 Rotate Engine Paddles and Remove the Engine Assembly

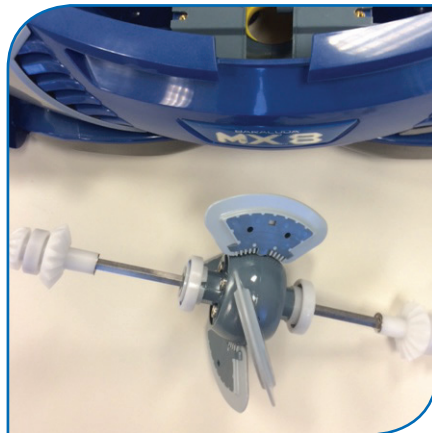
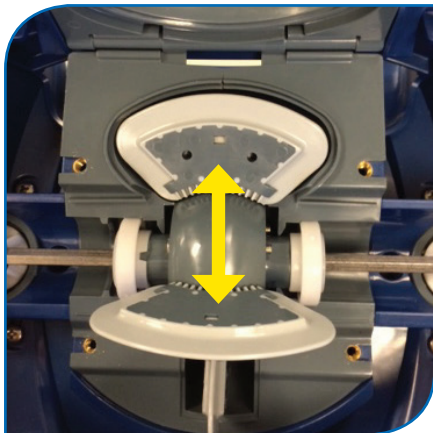

- Remove the engine and drive shaft assembly by holding both drive shafts and pulling firmly upward. Rotate the engine paddles if needed so that the engine can be easily removed.

4 Remove Screw and Side Body Assembly (2x)

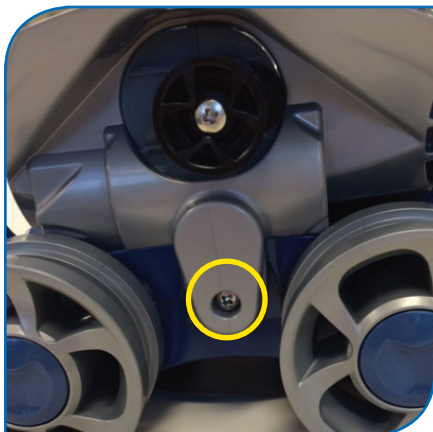

- Remove one screw from both left and right grey side body panels and remove both side panel assemblies.

5 Remove Screw and Reversing Assembly (2x)

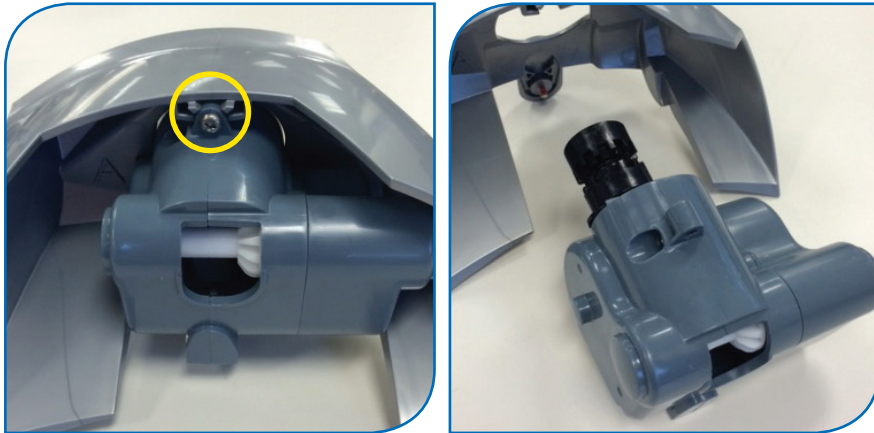

- Remove one screw and remove the reversing assembly from both side body assemblies.

Assembly

1 Install Reversing Assemblies (Match Letters A – A and B – B)

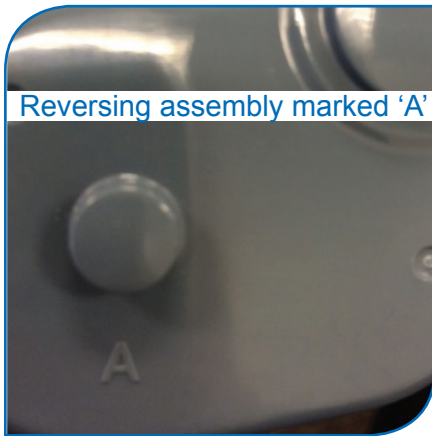

- Replace screw to install reversing assembly marked 'A' into side body housing marked 'A'. Repeat the step, replacing screw to install reversing assembly marked 'B' into side body housing marked 'B'.
- Replace screws in both left and right grey side body panels.

2 Install Bearings and Drive Shafts onto Engine

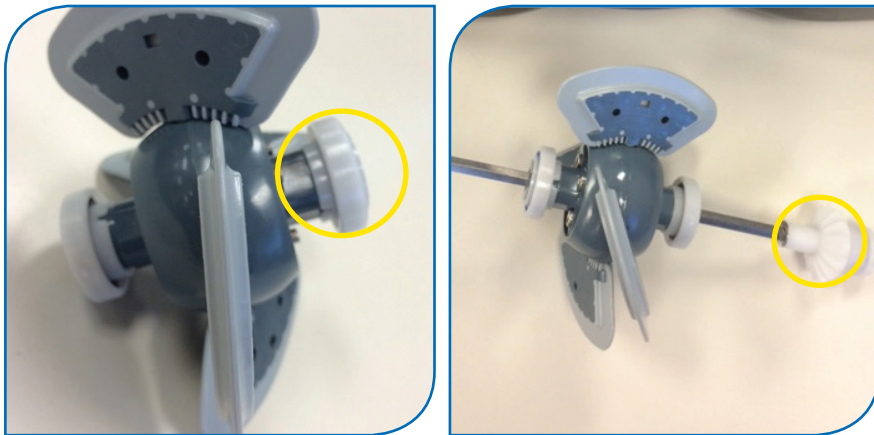

- Press bearings firmly onto either side of the engine, until bearing stops. Make sure the blue plastic piece on the bearing is facing away from the engine.
- Insert drive shafts into the engine and bearings.

3 Replace the Engine and Engine Housing

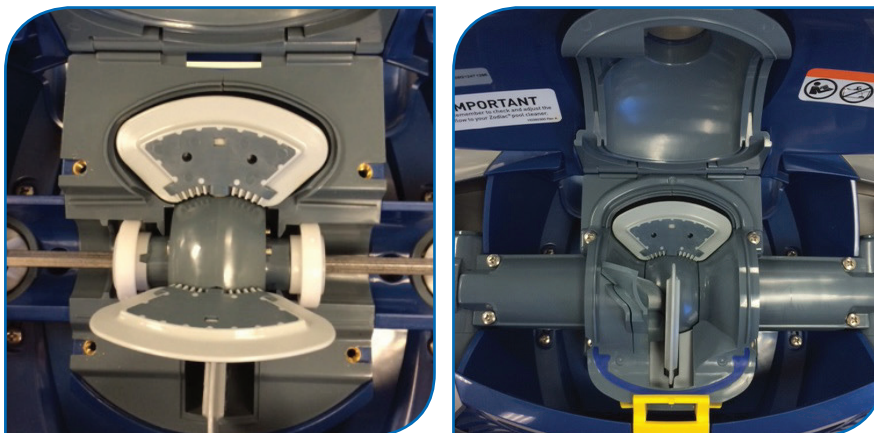

- Seat the engine assembly into the cleaner body. Slowly rotate the engine paddles if necessary.
- Replace the engine housing over the engine and paddles.

- Replace eight (8) screws.

4 Replace New Tracks

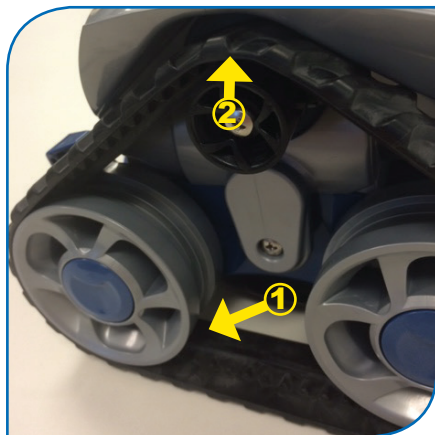

- Close the top of the cleaner, making sure the latch clicks in place.
- Replace new tracks.
- Place the raised inner track into the groove in the two bottom wheels.
- Pull gently up to seat the top of the track over the smaller black wheel.

Zodiac Group Australia Pty Ltd
1.300.763.021 | www.zodiac.com.au

ZODIAC® is a registered trademark of Zodiac International, S.A.S.U., used under license. All trademarks referenced herein are the property of their respective owners.

©2015 Zodiac Pool Systems, Inc. H0509700 Rev A

