

Robot operation

Set Up

Cable Tip:
Unwind the cable and stretch it out completely so that it has no kinks.

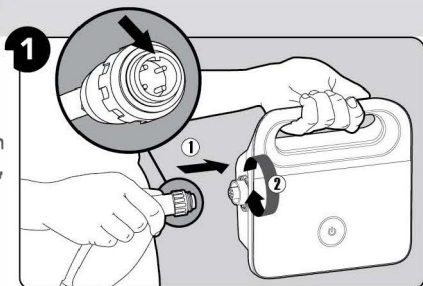

1 Attach the floating cable to the power supply.

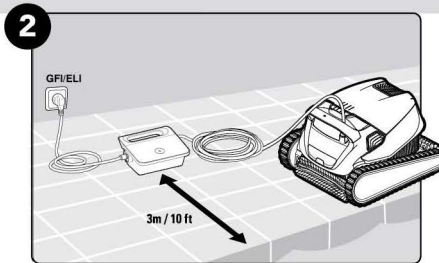

2 Position the power supply at least 3m/10ft away from the edge of the pool.

Into the pool

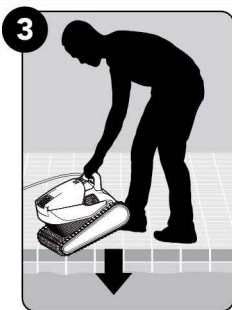

3 Put the Pool Cleaner into the pool. Release the Pool Cleaner and let it sink to the floor of the pool. Make sure that the floating cable is free of any obstructions.

Operation

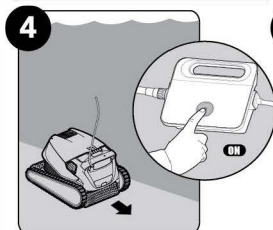

4 Turn the power supply ON. The Pool Cleaner will now operate until it has reached the end of the cleaning cycle.

Out of the pool



6 Cleaning the filter

It is highly recommended to clean the filter basket after each cleaning cycle.
Note: Don't let the filter cartridges dry out before cleaning.

⚠ Unplug the power supply before servicing

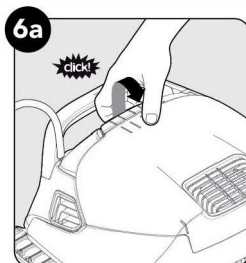

6a Open the filter cover.

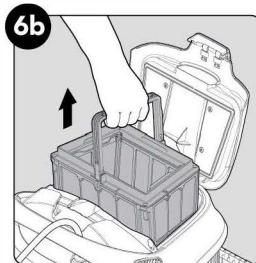

6b Lift up the basket.

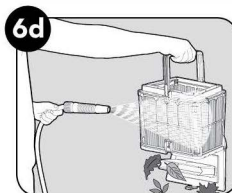
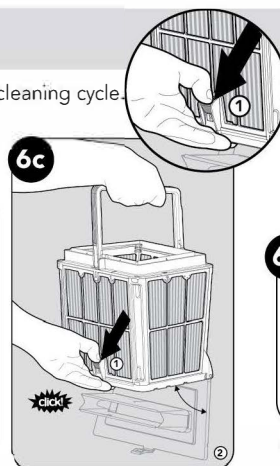

6d Clean the filter basket with a hose.

7 Storage

Coil the cable and store in a cool, dry place on the Caddy.
Do NOT store the robot where it will be exposed to direct sunlight, excessive heat or to frost.

Maintenance

Periodic filter cleaning

Dismantle the 4 ultra-fine filter panels of the outer basket according to the following steps:

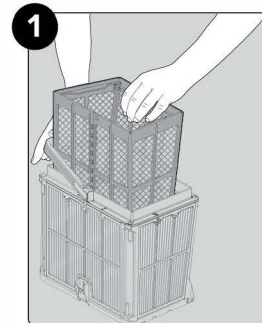

1 Holding down the handle remove the inner net basket. (optional Net Filter Insert)

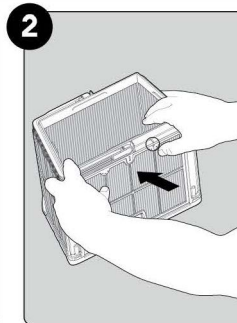

2 Dismantle the panels, starting with pressing on panel no. 1 using your thumbs.

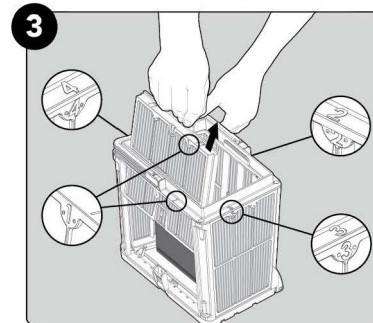

3 Continue to dismantle the panels in the order of their numbers: no. 2--> no. 3--> no. 4.

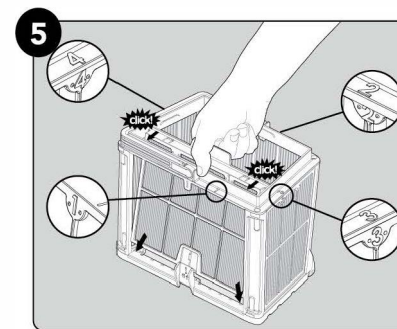
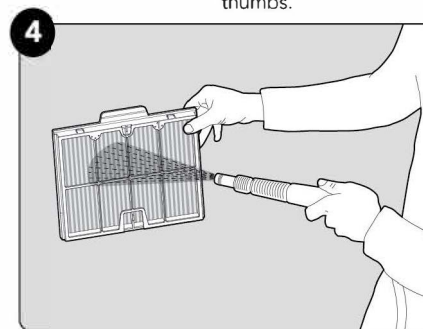

Cleaning the impeller

If you notice debris trapped in the impeller:

⚠ Unplug the power supply before servicing

Clean the debris trapped in the impeller opening, according to the following steps:

