

# MULTIPLUS

**INSTALLATION & USER  
GUIDE**

# CONTENTS

WIRING INFORMATION	3
MANUAL MODE USER INSTRUCTIONS	4
QUICK SETUP - iRIS	4
QUICK SETUP - CONNECT 10	5
QUICK SETUP - AQUALINK/INTELLITOUCH/EASYTOUCH	6
QUICK SETUP - AQUALINK RS/TRI	7
MANUAL MULTI PLUS SETUP	8
VERSION IDENTIFICATION	10
OPERATING MODE COLOURS	11

## READ FIRST

The MULTI-PLUS light has 7 inbuilt modes of operation for use on a variety of different control systems or installation types.

When you first install your MULTI-PLUS light it will operate in the default, 'Manual' mode for use with a wall switch. see **MANUAL MODE USER INSTRUCTIONS**

When connecting the light to a 3rd party pool controller you will need to change the operating mode of the light, for an expedited setup see **QUICK SETUP** guides for your corresponding pool controller.

If installing MULTI-PLUS lights with legacy Multi Colour and P-Type lights, see **MANUAL MULTI-PLUS SETUP**

## PRODUCT SUPPORT & INFORMATION

For further information or technical assistance please feel free to contact our Customer Service Department on:

Phone: +61 3 9793 2299

Email: [info@spaelectrics.com.au](mailto:info@spaelectrics.com.au)

Web: [www.spaelectrics.com.au](http://www.spaelectrics.com.au)

# WIRING INFORMATION

## MANUAL MODE OPERATION (SYNCHRONISED POOL & SPA)

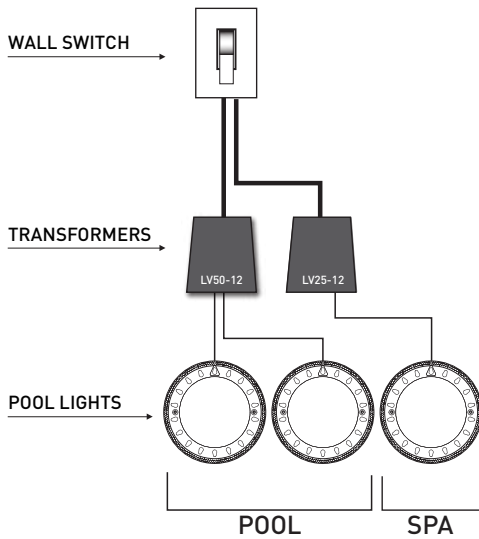

### SYNCHRONIZED INSTALLATION

When installing multiple lights, to ensure synchronization and ease of operation ALL Lights must operate from a single switch.

## CONNECTING TO POOL/LIGHTING CONTROLLER

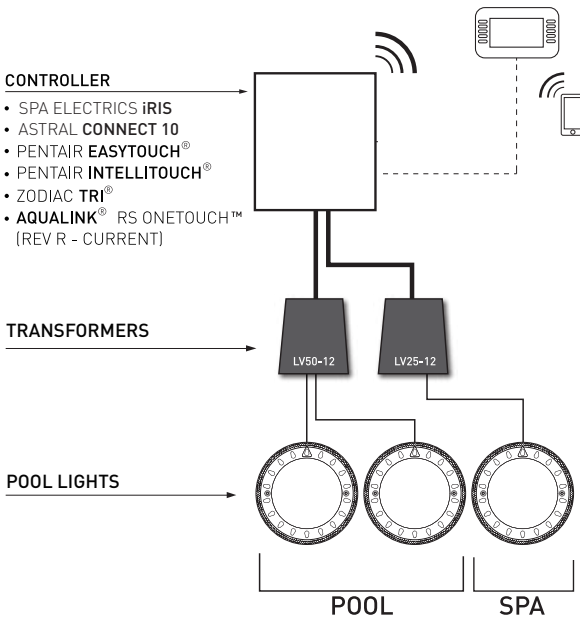

# MANUAL MODE USER INSTRUCTIONS

When installing multiple lights, to ensure synchronization and ease of operation ALL Lights must operate from a single switch.

## OPERATING INSTRUCTIONS

1. To change the color of the light, simply turn your light **OFF** for **2** seconds and then turn it back **ON**. This will signal the light to proceed to the next colour in sequence.  
To select a desired colour, simply step through the colours until you find your desired selection.

**Refer to OPERATING MODE COLOURS for available colours.**

2. Your lights will automatically save your selected colour once the power has been turned **OFF** for more than **1** minute. So the next time the lights are used, they will illuminate on the last colour operated.
3. To reset or '**synchronize**' your lights; with the power turned **ON**, turn the power **OFF/ON** once rapidly. This will **RESET** your lights to **WHITE**

## SYNCHRONIZED INSTALLATION

When installing multiple lights, to ensure synchronization and ease of operation ALL Lights must operate from a single switch.

# QUICK SETUP iRIS

The iRIS lighting controller has a QUICK SETUP feature to program the MULTI PLUS lights for iRIS operation.

### STEP 1

Ensure the lights have been **OFF** for a minimum of **30 seconds**, then turn the system **ON** using the iRIS handset.

### STEP 2

Press the following static colours in order with a **1 second** pause between each press.

1. **WHITE**
2. **RED**
3. **GREEN**

If performed correctly, the lights will illuminate **GREEN**. Confirm correct operation by selecting a different colour using the iRIS handset.

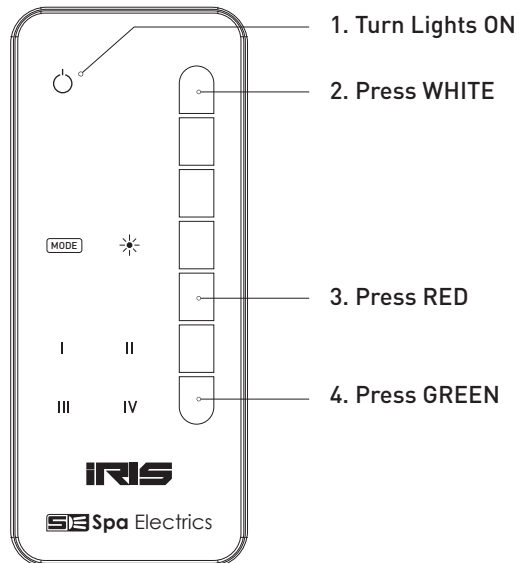

# QUICK SETUP CONNECT 10

**NOTE: QUICK SETUP - CONNECT 10 is only available with MULTI PLUS lights produced after 21/01/2018 - see "VERSION IDENTIFICATION" for details**

## STAGE 1 - POOL CONTROLLER SETUP

When connecting the Multi Plus light to a Connect 10 pool controller please ensure the system is fully installed and you have completed all the relevant steps in the controller setup menu to operate the lights correctly.

**During pool controller setup ensure that the "Zone supports Multi-Colour lighting" checkbox is selected and that the "SLX LIGHT" light model is selected.**

**During channel setup select "Yes" when prompted  
"Is this a multi-colour capable light?"**

(For more information on this please refer to the pool controller installation manual).

**NOTE: Some older pool controllers may not support these models.  
Please contact Spa Electrics assistance.**

## STAGE 2 - POOL LIGHT SETUP

**Step 1 - Ensure the light has been turned off for at least 30 seconds**

**Step 2 - Turn the light ON** using the Connect 10 Touchscreen

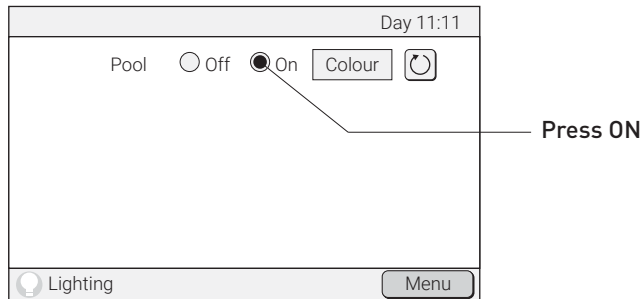

**Step 3 - Press the SYNC button,**

once the Connect 10 and Multi Plus Light have finished communicating the Multi Plus light can be operated using the Connect 10 pool controller  
(This step must be performed within 30 second of step 2)

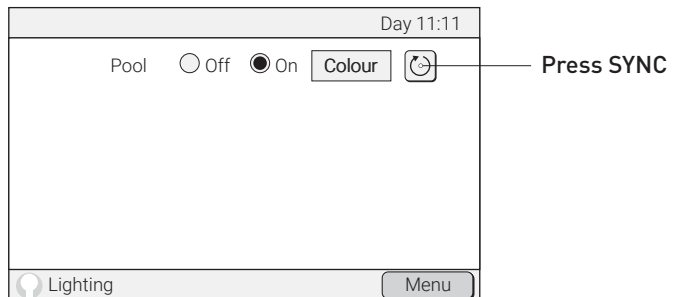

# QUICK SETUP AQUALINK INTELLITOUCH/EASYTOUCH

**NOTE: QUICK SETUP - INTELLITOUCH/EASYTOUCH is only available with MULTI PLUS lights produced after 21/01/2018**  
**- see "VERSION IDENTIFICATION" for details**

## STAGE 1 - POOL CONTROLLER SETUP

When connecting the Multi Plus light to an Intelitouch or Easytouch pool controller please ensure the system is fully installed and you have completed all the relevant steps in the controller setup menu to operate the lights correctly.

**During pool controller setup ensure that the light model selected is INTELLIBRITE LIGHT**

(For more information on this please refer to the pool controller installation manual).

**NOTE: Some older pool controllers may not support these models.**

Please contact Spa Electrics assistance.

## STAGE 2 - POOL LIGHT SETUP

**Step 1 - Ensure the light has been turned off for at least 30 seconds.**

**Step 2 - Navigate to the "Lights/Colors" menu on the pool controller Handset or Control Panel.**

**Step 3 - Select MAGENTA in the colour menu, and wait until the relays finish operating.**

**Step 4 - Select GREEN in the colour menu, and wait until the relays finish operating.**

**Step 5 - Select BLUE in the colour menu, and wait until the relays finish operating.**

**Step 6 - After 3 seconds the Multi Plus light will turn itself off for 1.5 seconds and turn on BLUE. This will indicate that the mode setup has been completed correctly**

Note: Steps 3-5 must be performed within 5-90 seconds of the end of the previous Step

### INTELLITOUCH/EASY TOUCH CONTROLLERS



### AQUALINK TRI CONTROLLERS

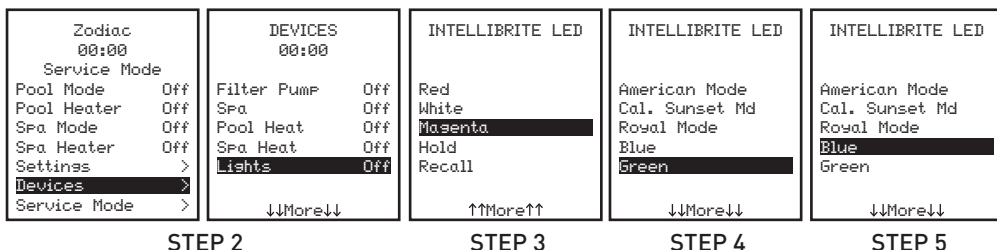

# QUICK SETUP AQUALINK RS/TRI

**NOTE: QUICK SETUP - AQUALINK RS/TRI is only available with MULTI PLUS lights produced after 21/01/2018 - see "VERSION IDENTIFICATION" for details**

## STAGE 1 - POOL CONTROLLER SETUP

When connecting the Multi Plus light to an Aqualink RS/Z4 pool controller please ensure the system is fully installed and you have completed all the relevant steps in the controller setup menu to operate the lights correctly.

**During pool controller setup ensure that the light model selected is  
JANDY LED LIGHT**

(For more information on this please refer to the pool controller installation manual).

**NOTE: Some older pool controllers may not support these models. Please contact the controller manufacturer for upgrade assistance.**

## STAGE 2 - POOL LIGHT SETUP

**Step 1 - Ensure the light has been turned off for at least 30 seconds.**

**Step 2 - From the home screen on the control panel, Select "Equipment ON/OFF".**

**Step 3 - Select the channel for the lights, each channel will need to be setup individually.**

**Step 4 - Select DISCO TECH in the "Set Color" menu.**

**Step 5 - After the controller finishes power cycling, the Multi Plus light will turn itself off for 1.5 seconds and turn on DISCO TECH. This will indicate that the mode setup has been completed correctly**

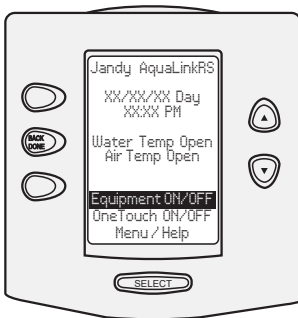

Step 2

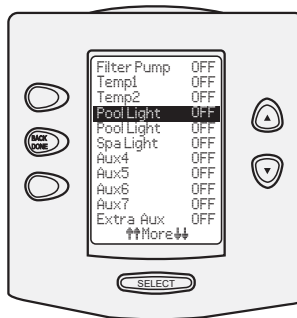

Step 3

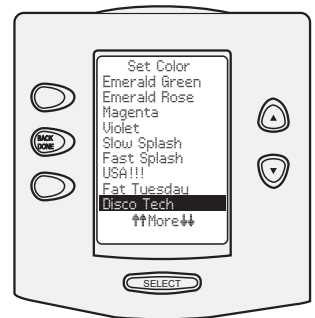

Step 4

# MANUAL MULTI PLUS SETUP

Manual Multi Plus Setup is for installations where the use of a quick setup is not possible or a new MULTI-PLUS light is being installed with an existing Multi Colour or P-Type light.

The MULTI-PLUS light has 7 inbuilt modes of operation for use on a variety of different control systems or installation types.

When you first install your MULTI-PLUS light it will operate in the default, 'Manual' mode for use with a wall switch. In order to connect the light to a 3rd party pool controller OR change to a different operating mode please follow the below steps.

## STEP 1 - POOL CONTROLLER SETUP

If connecting to a pool controller, please ensure the system is fully installed and you have completed all the relevant steps in the controller setup menu to operate the lights correctly.

**During pool controller setup you will be prompted to select which light model is installed. Please use the below table to select the appropriate light for your pool controller type.**

(For more information on this please refer to the pool controller installation manual).

POOL CONTROLLER	SELECT LIGHT MODEL
Astral <b>Connect 10</b> (2016 to current)	SLX Light
Jandy <b>Aqualink RS</b> (F/W Rev. 'R' - Current)	Jandy
Zodiac <b>Aqualink TRI</b>	Jandy
Pentair <b>EasyTouch</b>	Intellibrite Light
Pentair <b>IntelliTouch</b>	Intellibrite Light
Hayward <b>Omnilogic</b>	(UCL)Universal Colorlogic

**NOTE:** Some older pool controllers may not support these models. Please contact the controller manufacturer for upgrade assistance.

## STEP 2 - LIGHT SETUP

**IMPORTANT:** Ensure Lights have been off for at least **30 seconds** prior to performing this step.

**NOTE:** This step can either be performed via a wall switch OR via the controller panel/Mobile App.

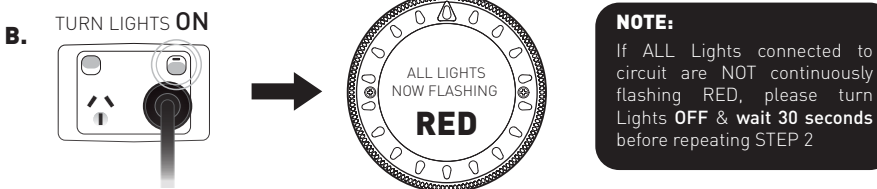
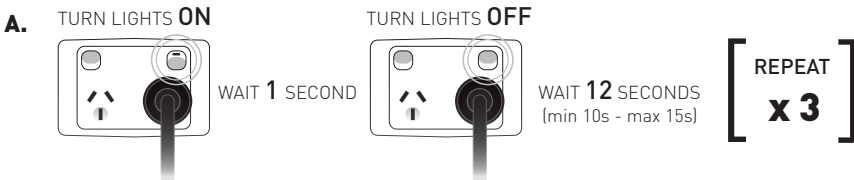

Continue to STEP 3



# MANUAL MULTI PLUS SETUP cont.

## STEP 3 - SELECTING OPERATING MODE

After accessing SETUP MODE (STEP 2) the lights will **FLASH RED** continuously. This is MODE 1 (Manual mode)

Use the below process to change the operating mode to correspond to the required controller or operating type below.

TURN LIGHTS **OFF**

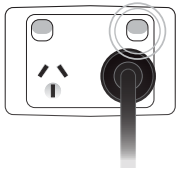

WAIT **1 SECOND**

TURN LIGHTS **ON**

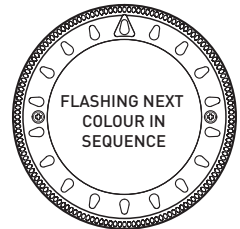
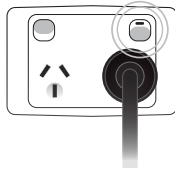

**IMPORTANT:** Once desired mode is reached (i.e. "Flashing Green - iRIS Mode) leave power turned ON and continue to STEP 4

'FLASHING' COLOUR	CONTROLLER / OPERATING TYPE	LIGHT MODEL SELECTED*
1. RED	Manual Mode (wall switch)	-
2. GREEN	Spa Electrics iRIS Controller	-
3. MAGENTA	Astral Connect 10 (2016 to current)	SLX Light
4. WHITE	Jandy Aqualink RS (F/W Rev. 'R'-Current)	Intellibrite Light
	Zodiac Aqualink TRI	Intellibrite Light
	Pentair EasyTouch	Intellibrite Light
	Pentair IntelliTouch	Intellibrite Light
5. BLUE	RGB MULTI Mode* (wall switch)	-
6. YELLOW	Hayward Omnilogic	Universal Colorlogic
7. PINK	P-TYPE Mode* (Legacy)	Intellibrite Light
8. AQUA	Aqualink RS/Z4	Jandy

Continue to STEP 4



### \*Light Model Selected:

This indicates the model of light to be selected in the Pool Controller setup menu.

Refer to STEP 1 on the previous page, for more information or please contact Spa Electrics. (03) 9793 2299

### \*RGB MULTI Mode:

This mode allows the MULTI PLUS light to operate in the standard MULTI-Colour mode. This mode should only be used when operating a MULTI PLUS light from a wall switch with a standard Spa Electrics MULTI-Colour light. For more information please contact Spa Electrics.

### \*P-TYPE Mode:

This mode allows the MULTI PLUS light to operate in the RGB P-Type Colour mode. This mode should only be used when operating a MULTI PLUS light in conjunction with an existing Spa Electrics P-Type light. For more information please contact Spa Electrics.

# MANUAL MULTI PLUS SETUP cont.

## STEP 4 - SAVING OPERATING MODE

Once the desired operating mode is selected follow these steps to save the selection.

TURN SYSTEM **OFF**

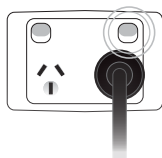

WAIT **30 SECONDS**

TURN SYSTEM **ON**

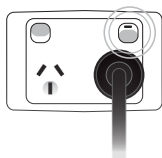

### Important

You must wait at least **30 Seconds** prior to turning the system back **ON** or selection process will fail and setup will need to be restarted.

## STEP 5 - CONFIRM OPERATION

Your setup should now be complete. To confirm the system is working correctly, select a colour via the controller or wall switch (depending on operating mode selected) and check to ensure all lights are synchronised and the correct colour is displayed.

Refer to **OPERATING MODE COLOURS** for available colours.

## VERSION IDENTIFICATION

New Features such as QUICK SETUP for selected pool controllers are not available in older versions of the MULTI PLUS lights. These features are only available in MULTI PLUS lights produced after 21/01/18.

The Production Date of your light can be located in the lower right corner of the product label adhered to the light's packaging.

If the light has been removed from it's packaging, you can identify if the QUICK SETUP features are available to your MULTI PLUS light, by comparing the serial number attached to the light to the table below:

LIGHT SERIES	CONNECT 10, INTELLITOUCH, EASYTOUCH, OMNILOGIC	AQUALINK RS/TRI
WN	WN-27964 and Greater	WN-43973 and Greater
GK	GK-103398 and Greater	GK-106189 and Greater
EM	EM-78510 and Greater	EM-96899 and Greater
WNRX	WX-07079 and Greater	WX-11176 and Greater
GKRX	GX-32314 and Greater	GX-52027 and Greater
EMRX	EX-02348 and Greater	EX-03847 and Greater

# OPERATING MODE COLOURS

## MANUAL MODE (DEFAULT)

1	WHITE 4000K
2	AQUA
3	BLUE
4	MAGENTA
5	RED
6	LIME
7	GREEN
8	OCEANIC VIEWS
9	TRANSCENDENCE
10	OUTBACK AUSTRALIA
11	SPRING EQUINOX

## IRIS MODE

1	WHITE 4000K
2	AQUA
3	BLUE
4	MAGENTA
5	RED
6	LIME
7	GREEN
8	OCEANIC VIEWS
9	TRANSCENDENCE
10	OUTBACK AUSTRALIA
11	SPRING EQUINOX

## CONNECT 10 MODE

1	BLUE
2	MAGENTA
3	RED
4	ORANGE
5	GREEN
6	AQUA
7	WHITE
8	CUSTOMISED COLOUR
9	RAINBOW PATTERN
10	OCEAN PATTERN
11	DISCO PATTERN

## UNIVERSAL COLORLOGIC MODE

1	VOODOO LOUNGE
2	DEEP BLUE SEA
3	ROYAL BLUE
4	AFTERNOON SKIES
5	AQUA GREEN
6	EMERALD
7	CLOUD WHITE
8	WARM RED
9	FLAMINGO
10	VIVID VIOLET
11	SANGRIA
12	TWILIGHT
13	TRANQUILITY
14	GEMSTONE
15	USA
16	MARDI GRAS
17	COOL CABARET

## INTELLIBRITE MODE

1	SAM
2	PARTY
3	ROMANCE
4	CARIBBEAN
5	AMERICAN
6	CALIFORNIA SUNSET
7	ROYAL
8	BLUE
9	GREEN
10	RED
11	WHITE
12	MAGENTA

## JANDY MODE

1	ALPHA WHITE
2	SKY BLUE
3	COBALT BLUE
4	CARIBBEAN BLUE
5	SPRING GREEN
6	EMERALD GREEN
7	EMERALD ROSE
8	MAGENTA
9	VIOLET
10	SLOW COLOR SPLASH
11	FAST COLOR SPLASH
12	AMERICA THE BEAUTIFUL
13	FAT TUESDAY
14	DISCO TECH

## P-TYPE MODE

1	SAM
2	PARTY
3	ROMANCE
4	CARIBBEAN
5	AMERICAN
6	CALIFORNIA SUNSET
7	ROYAL
8	BLUE
9	GREEN
10	RED
11	WHITE
12	MAGENTA

## STANDARD MULTI\* MODE

1	BLUE
2	MAGENTA
3	RED
4	LIME
5	GREEN
6	AQUA
7	WHITE 1
8	WHITE 2
9	SLOW COLOUR BLEND
10	FAST COLOUR CHANGE

### \*Standard MULTI Mode:

This mode allows the MULTI PLUS light to operate in the standard MULTI-Colour mode. This mode should only be used when operating a MULTI PLUS light from a wall switch or RM-2, in conjunction with a standard Spa Electrics MULTI-Colour light.



© COPYRIGHT 2019 SPA ELECTRICS PTY. LTD.

ALL RIGHTS RESERVED

Connect 10® is a registered trademark of AstralPool Australia and/or its affiliated companies in the United states or other countries.  
IntelliBrite® is a registered trademark of Pentair Water Pool and Spa, Inc and/or its affiliated companies in the United states or other countries.  
Colorlogic® is a registered trademark of Hayward Industries Inc. and/or its affiliated companies in the United states or other countries.  
Aqualink® is a registered trademark of Zodiac group Australia and/or its affiliated companies in the United states or other countries.  
Spa Electrics Pty Ltd and it's brands are not affiliated or endorsed by these companies and/or their brands.

20191018